

Entering the Ballot Online

For MACH 2028 only entries submitted via the online form will be accepted in order to help us ensure all submissions are recorded correctly.

Please refer to the following guidance if you need assistance in completing the form

1) The following key information is required

We need you to log your intention to enter the ballot via the online form but only the following information is required:

- Company
- Name
- Email
- Contact Number

2) Add supporting documents & notes

If you prefer to send us your actual stand choices and supporting documents via email or as attachments then you are free to do so, please just make sure any supporting documents are clearly labelled so we can match them up with your online entry.

We have a template you can download if you prefer to type/write out your choices which is attached to the online form for you to download.

There is plenty of space in the online form to add more information, in the section pictured below you can add supporting files in pdf or docx form, image files are also supported:

Additional Information

If you would like to upload plans, notes or other files to support your application |

Supporting Document 1

Ballot Test Info.png

Max. file size: 8 MB.

Please note attachments are not retained when you save a form and return to it later

General Notes

Please see additional info sent via email

There is also space to add notes directly to the form if there is something you would like us to keep in mind when processing your application.

3) Example Entry

Just in case, here is an example of how to fill in the choices section:

Ballot Choices

Choice Number (Ranking)	Stand Number	Length	Width	Area	Notes
1	26-868	10	10	100	
2	26-123	11	10	110	Top half
3	26-789	10	9	90	left hand section
4	26-875	11	9	99	as drawn

Don't forget to use the '+' sign at the end to add rows as needed.

If you are splitting a stand remember to let us know which section is your preferred location.

4) An easy way to mark up the plan on your computer

For those of you using the Microsoft suite then the 'Snipping Tool' is a great way to grab and mark-up sections of the plans. You can find it by hitting the Print Screen function on your keyboard or searching for the app:

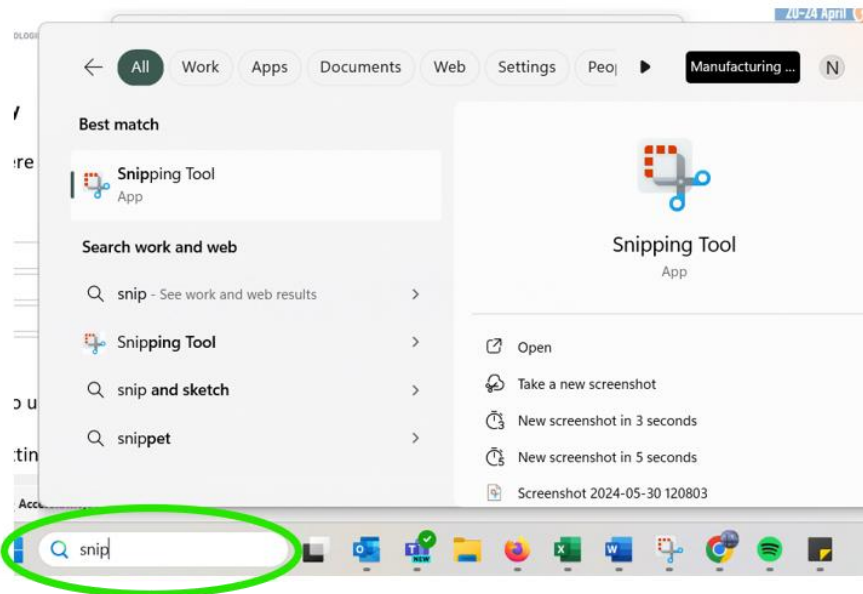

You can then easily grab the section of the floorplan you are interested in and add notes:

Handwrite notes
like choice numbers

Erase any errors!

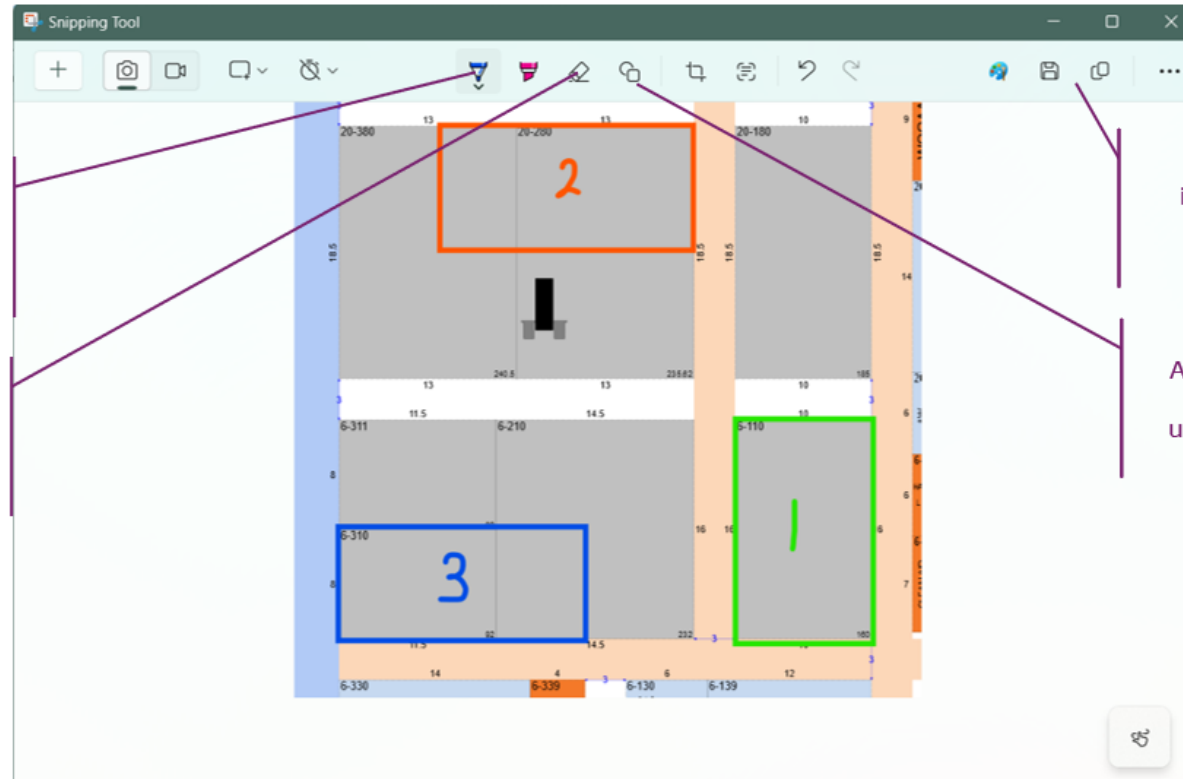

Save your snip as an
image file or copy it to
paste it directly into
another file

Add boxes to your
floorplan snip
using this function

No scanners or printers needed 😊